

# PROCESS WATER CHILLERS

**PRODUCTS COLLECTION**  
2019 EDITION

[www.eurochiller.com](http://www.eurochiller.com)

 **EURO  
CHILLER**<sup>®</sup>  
INTERNATIONAL COOLING





63 - 920 kW



### DCOOLER

Cooling capacity 63/920 kW

### DCOOLER-LN - low noise version

Cooling capacity 43/588 kW

### STANDARD version

### SELF DRAINING version

### DCOOLER-AD

Cooling capacity 63/920 kW

### DCOOLER-AD-LN - low noise version

Cooling capacity 43/588 kW



**IT** Dcooler è un dry-cooler dagli alti contenuti innovativi e un prezzo estremamente competitivo. La struttura della macchina e le sue caratteristiche sono assimilabili a quelle dell'ADcooler con funzionamento a bulbo secco, senza le performance del sistema adiabatico.

<b>STRUTTURA</b>	In acciaio zincato pre-verniciato per posizionamento all'esterno
<b>BATTERIA DI SCAMBIO</b>	Rame/alluminio
<b>VERSIONE AUTO-DRENANTE</b>	Optional. Permette il funzionamento senza l'utilizzo di glicole antigelo
<b>STRUMENTO DI CONTROLLO</b>	Sistema di controllo a microprocessore
<b>CERTIFICAZIONI</b>	CE

**EN** Dcooler is a dry-cooler with a highly innovative content and a very competitive price. The structure of the unit and its characteristics are similar to those of the ADcooler with dry bulb operation, without the performance of the adiabatic system.

<b>STRUCTURE</b>	Structure manufactured from pre-painted galvanized steel suitable for outdoor installation
<b>HEAT EXCHANGE COILS</b>	Copper/aluminium
<b>SELF-DRAINING VERSION</b>	Optional. It allows the operation of the unit without glycol
<b>CONTROL</b>	Microprocessor control
<b>CERTIFICATE</b>	CE

**DE** Dcooler ist ein Freikühler mit hoher Ausführung und einem wettbewerbsfähigen Preis. Der Aufbau, sowie die Eigenschaften der Geräte sind ähnlich wie die der ADcooler für Trockenkugeltemperaturbetrieb ohne das Adiabatiksystem.

<b>STRUKTUR</b>	Gerätegehäuse aus vorbeschichtetem verzinktem Stahl zur Außenaufstellung
<b>AUSTAUSCHBATTERIEN</b>	Kupfer/Aluminium
<b>SELBSTENTLEERENDE VERSION</b>	Optional. Für den Betrieb ohne Glykol
<b>KONTROLLE</b>	Mikroprozessorbedienfeld
<b>ZERTIFIZIERUNG</b>	CE

**FR** Dcooler est un produit innovant et ceci à un prix des plus compétitifs. La structure de la machine ainsi que ses caractéristiques ressemblent à celles de l'ADcooler avec fonctionnement en bulbe sec, mais sans les performances du système adiabatique.

<b>STRUCTURE</b>	Structure en acier zingué galvanisé pré-peint pour l'extérieur
<b>BATTERIE D'ÉCHANGE</b>	Cuivre/aluminium
<b>VERSION AUTO-VIDANGEABLE</b>	Option. Pour fonctionnement sans glycol
<b>CONTRÔLE</b>	Panneau de commande à microprocesseur (en option)
<b>CERTIFICATIONS</b>	CE

**ES** Dcooler es un dry-cooler muy innovativo a un precio muy competitivo. La máquina y sus características son similares a los del ADcooler con funcionamiento a bulbo seco, sin los rendimientos del sistema adiabático.

<b>ESTRUCTURA</b>	De acero galvanizado prepintado para el exterior
<b>BATERÍAS DE INTERCAMBIO</b>	Cobre/Aluminio
<b>VERSIÓN AUTODRENANTE</b>	Optional. Puede funcionar sin glicol
<b>CONTROL</b>	Panel del mando con microprocesador
<b>CERTIFICACIONES</b>	CE

## HORIZON

Permette la **supervisione di una rete di macchine EUROCHILLER** (max. 10) come un unico sistema, ottimizzandone il funzionamento, **facendo interagire tutte le unità tra di loro in modo dinamico in funzione delle richieste dell'utenza e delle condizioni ambientali.**

Il sistema è predisposto per il monitoraggio remoto macchine ON-AIR.

It allows the **supervision of a network of EUROCHILLER machines** (max 10) as a single system, optimizing their operation, **letting all the units interact dynamically, according to the user's requirements and to the environmental conditions.** The system includes the ON-AIR monitoring control.

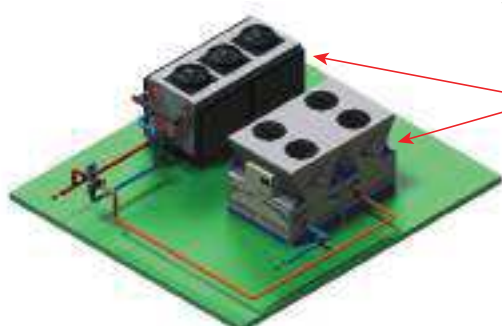

### SISTEMA DI SUPERVISIONE UNITÀ HORIZON

### HORIZON SYSTEM FOR UNITS SUPERVISION



## E-BRAIN control

Permette l'**ottimizzazione della temperatura dell'acqua di condensazione degli IceTemp** (max. 15) in funzione della temperatura ambiente e dei vari set-point impostati per l'acqua di processo, **regolando automaticamente il set-point di ADC/DC** (max. 5) per garantire la massima efficienza degli IceTemp-FC

It allows the **optimization of the condensing water of the IceTemp** (max. 15) according to the ambient temperature and the different set-points of the process water, **automatically adjusting the set-point of the ADC/DC** (max. 5) to grant the best efficiency of the IceTemp-FC.

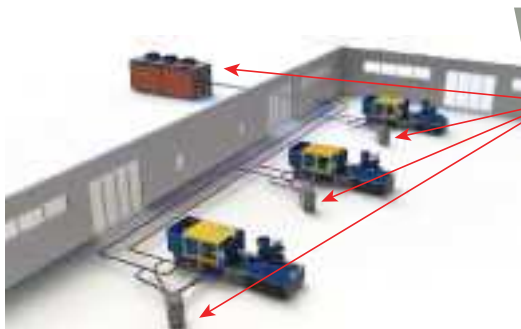

### SISTEMA DI INTERFACCIAMENTO ICETEMP-FC CON ADC/DC

### SYSTEM FOR ICETEMP-FC AND ADC/DC INTERFACE

# REMOTE CONTROL and SYSTEM MONITORING

## EUROCHILLER ON-AIR

### SISTEMA DI CONTROLLO REMOTO ON-AIR

### ON-AIR REMOTE CONTROL SYSTEM



Sistema di monitoraggio remoto dei nostri sistemi di refrigerazione e termoregolazione, che permette:  
Remote control system of our cooling and temperature control units, allowing:



**SUPERVISIONE LOCALE:** Monitoraggio in loco a cura dell'utente finale.  
**LOCAL SUPERVISION:** On site monitoring by the end-user.

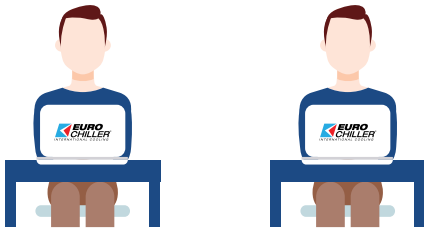

**MONITORAGGIO REMOTO:** Controllo in linea del funzionamento dell'unità e dei suoi parametri (a cura EUROCHILLER o centro assistenza autorizzato).  
**REMOTE MONITORING:** On-line control of the operation of the unit and of its parameters (EUROCHILLER or authorized technical service).



**ASSISTENZA REMOTA:** Interazione con l'utente finale in caso di anomalie.  
**REMOTE ASSISTANCE:** Interaction with the end-user in case of malfunctions.



**INTERVENTO IMMEDIATO:** L'assistenza rileva in tempo reale la necessità di intervenire e può quindi reagire con immediatezza.  
**PROMPT INTERVENTION:** The service is notified in real time when intervention is required and may react promptly.



**REPORT TRIMESTRALI:** Report dettagliati delle condizioni di lavoro.  
**QUARTERLY REPORTS:** Detailed reports of operating conditions.

# PROCESS AIR CHILLERS & DEHUMIDIFIERS

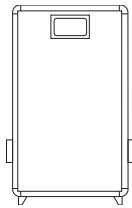

11-19 kW 1000-1500 m<sup>3</sup>/h

**MINI ABF**

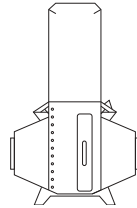

13-94 kW 1000-7500 m<sup>3</sup>/h

**AIR+**

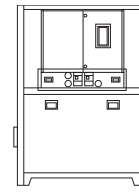

29-230 kW 2000-10000 m<sup>3</sup>/h

**ABFevo**

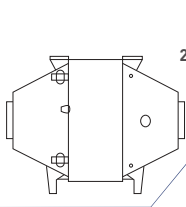

2-169 kW 250-17000 m<sup>3</sup>/h

**BRA+**

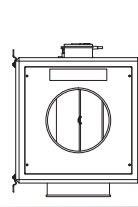

max. 20000 m<sup>3</sup>/h

**AMK**

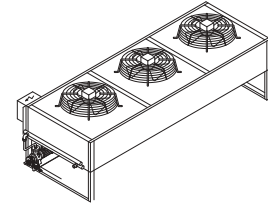

21-200 kW

**OFC KIT**

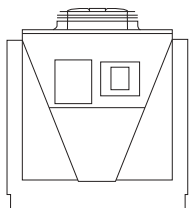

82-1220 kW

**ADcooler KIT**

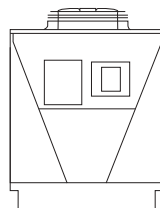

63-920 kW

**Dcooler KIT**

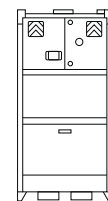

400-3000 m<sup>3</sup>/h

**EU-DRYmould**

# TEMPERATURE CONTROLL UNITS

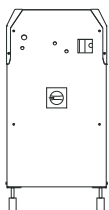

3 - 12 kW

**STARTY**

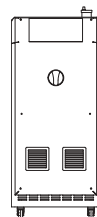

3 - 24 kW

**MAXY**

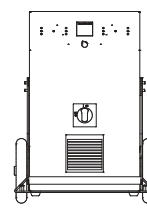

3 - 24 kW

**3FLOWSevo**

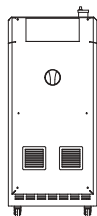

3 - 12 kW

**3FLEX**



3 - 150 kW

**ETO - ETW**

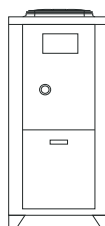

6 - 36 kW 13 - 130 kW

**ROSSOBLU**

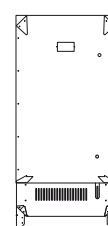

3 - 18 kW 4 - 98 kW

**ICETEMP**





# PROCESS WATER CHILLERS

**PRODUCTS COLLECTION**  
2019 EDITION

EUROCHILLER S.r.l. - Via Milano, 69 - 27030 Castello d'Agogna - PV - Italy  
Tel. +39 0384.298985 - Fax +39 0384.298984 - Service +39 0384.298981  
enquiry@eurochiller.com - www.eurochiller.com

 **EUROCHILLERGROUP**